

IMPORTANT: On 1 September 2017, this product (among others) was temporarily suspended while we investigate the results of recent tests (Parts 6 and 7 of British Standard 476). In addition, we have recently identified a compliance issue relating to our calculation and testing of the declared lambda value of products in the 4000 and 5000 ranges and the Crown-Bond and Crown-Fix products within the Crown Flat Roofing range. Materials relating to this product are for information only.

Celotex SL5000 is our premium performance PIR solution. Through ongoing product innovation and breakthrough design, SL5000 represents pioneering progression within the PIR market combining premium performance PIR insulation bonded to 6mm calcium silicate.

Celotex SL5000 is specifically designed for soffit liner applications.

SL5000 is manufactured from rigid polyisocyanurate (PIR) using a blowing agent that has low global warming potential (GWP) and zero ozone depletion potential (ODP). With Celotex SL5000 you are specifying an insulation board that:

- Combines the PIR properties of Celotex insulation with calcium silicate providing additional fire performance
- Achieves a lambda value of 0.021 W/mK offering enhanced thermal performance and lower U-values
- Features Class O fire performance
- Is A+ rated (insulation only) when compared to the BRE Green Guide rating
- SL5000 is supported by the Celotex Technical Centre and Thermal Bridging Models

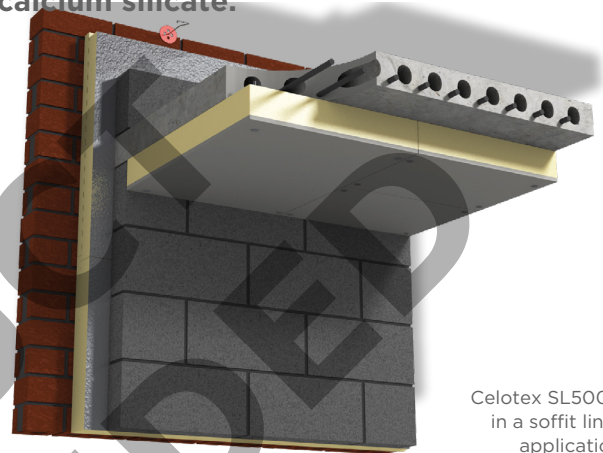

Celotex SL5000
in a soffit liner
application

Applications

Use Celotex SL5000 PIR insulation in concrete soffit liner applications.

Specification clause

The concrete soffit liner insulation shall be Celotex SL5000 ____mm thick, comprising a polyisocyanurate (PIR) rigid foam insulation core bonded to a layer of 6mm calcium silicate. The insulation component of SL5000 is A+ rated when compared to the BRE Green Guide, is CFC/HCFC free with low GWP and zero ODP and achieves CE marking compliance to BS EN 13165. The product is manufactured in accordance with quality management systems ISO 9001 and environmental management system ISO 14001. All products must be installed in accordance with instructions issued by Celotex.

Technical data

Thickness (mm)*	R-value (m ² K/W)	Weight (kg/m ²)
86	3.85	9.66
96	4.30	9.98
106	4.80	10.30

*thickness includes insulation + 6mm calcium silicate board

Physical properties

	Method	SL5000
Compressive strength	BS EN 826	≥120kPa
Dimensional stability	BS EN 1604	DS (70, 90)3, DS (-20,-)1
Water vapour resistance	BS EN 12086: Method B	>150 MNs/g
Thermal conductivity	BS EN 12667	0.021 W/mK
Fire propagation	BS 476: Part 6	Pass
Surface spread of flame	BS 476: Part 7	Class 1

Further information

If you wish to contact Celotex, please do so through the 'contact us' page on our website. For information regarding storage, installation and handling of Celotex products, or for health & safety advice, please refer to our online 'literature' pages.

Celotex has a policy of continuous product development and reserves the right to alter product designs or specifications without prior notice.

Saint-Gobain Construction Products UK Limited trading as Celotex. Registered Office: Saint-Gobain House, Binley Business Park, Coventry CV3 2TT. Registered in England and Wales No 734396